

COOLING

Plate 05-1

C-2918

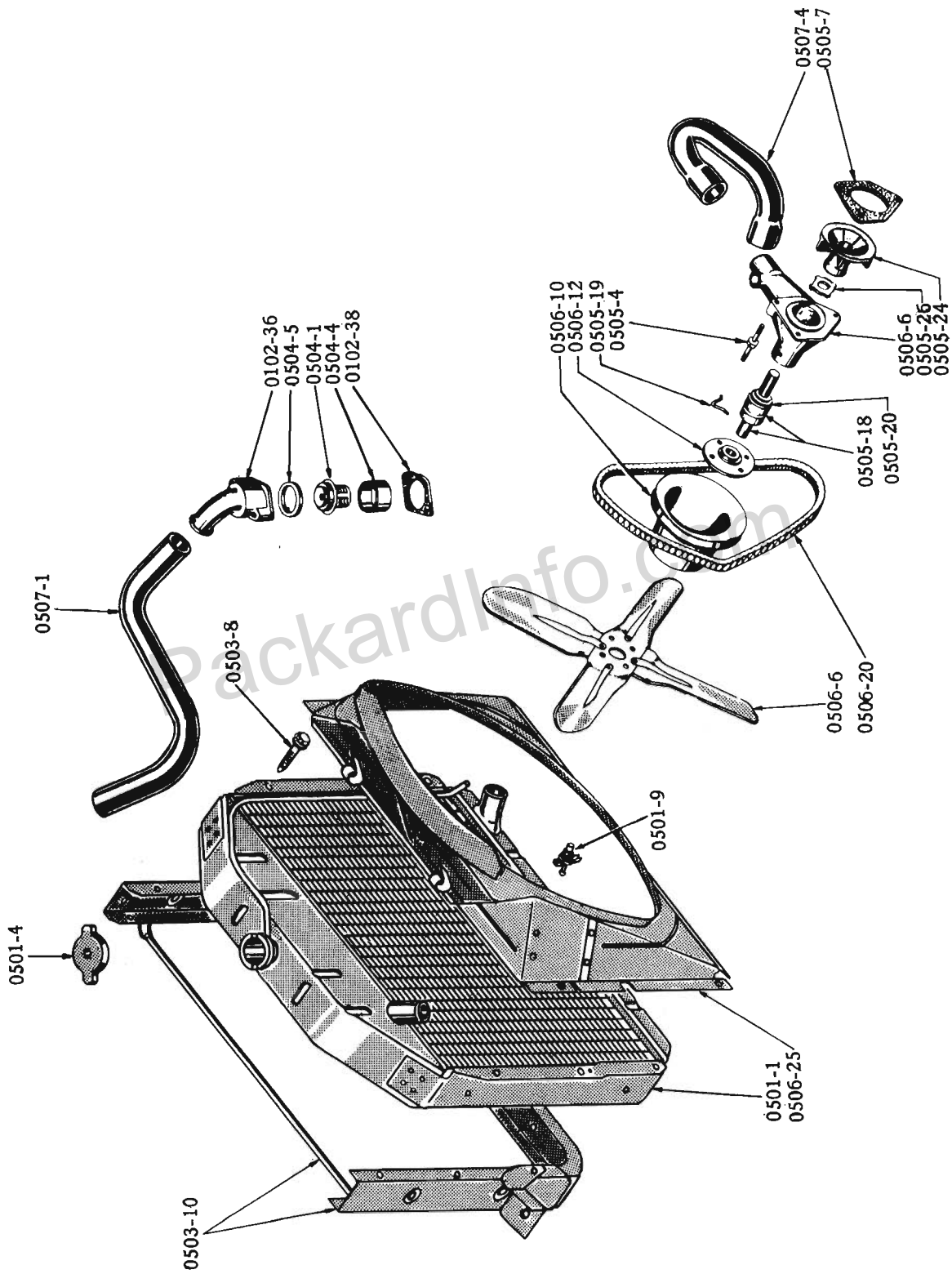

RADIATOR, FAN and WATER PUMP - Models 16G6, 56G, 57G

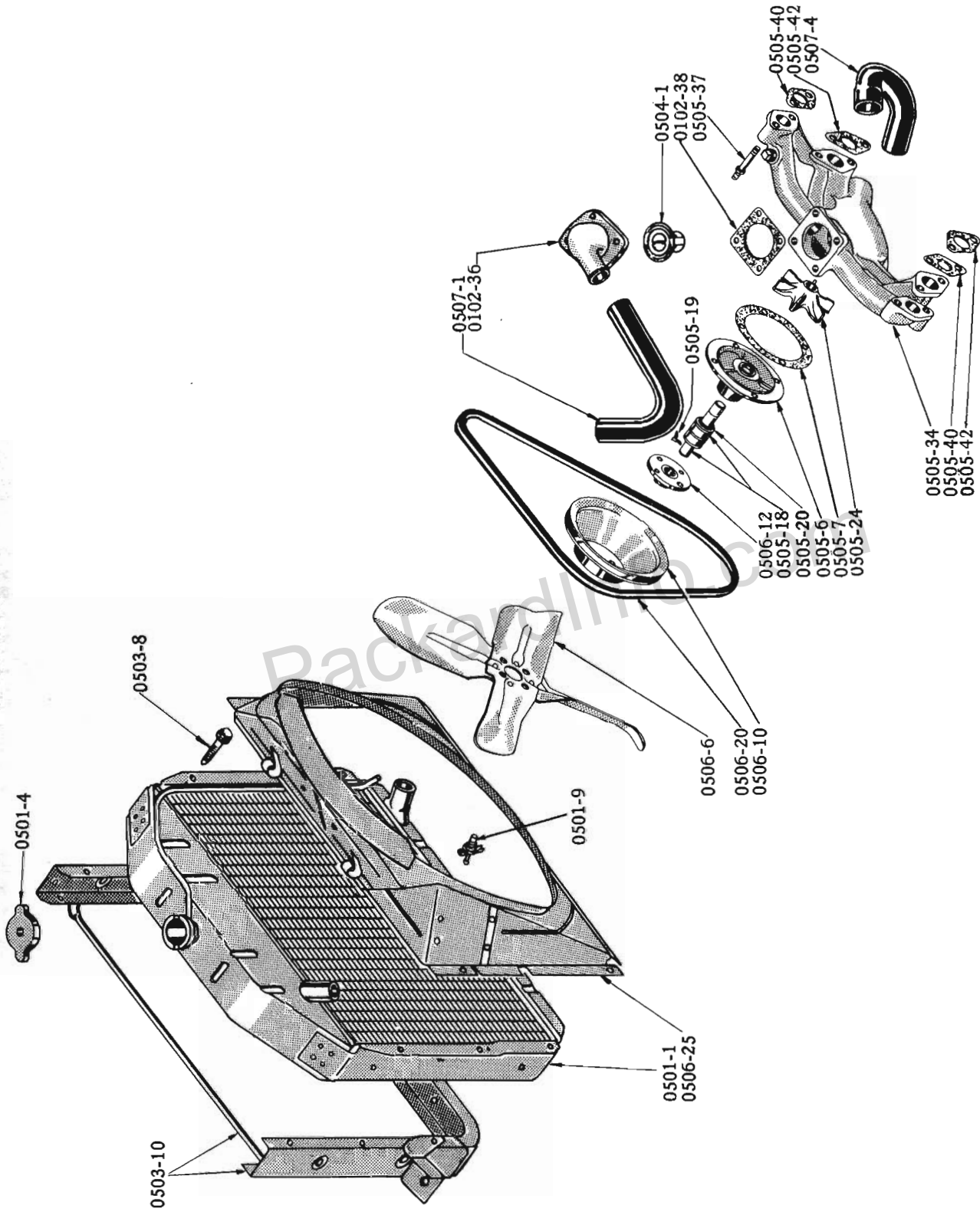

C-2919

RADIATOR, FAN and WATER PUMP - Models 16G8, 6H, 56B, 56H, 57B, 57H, 57L

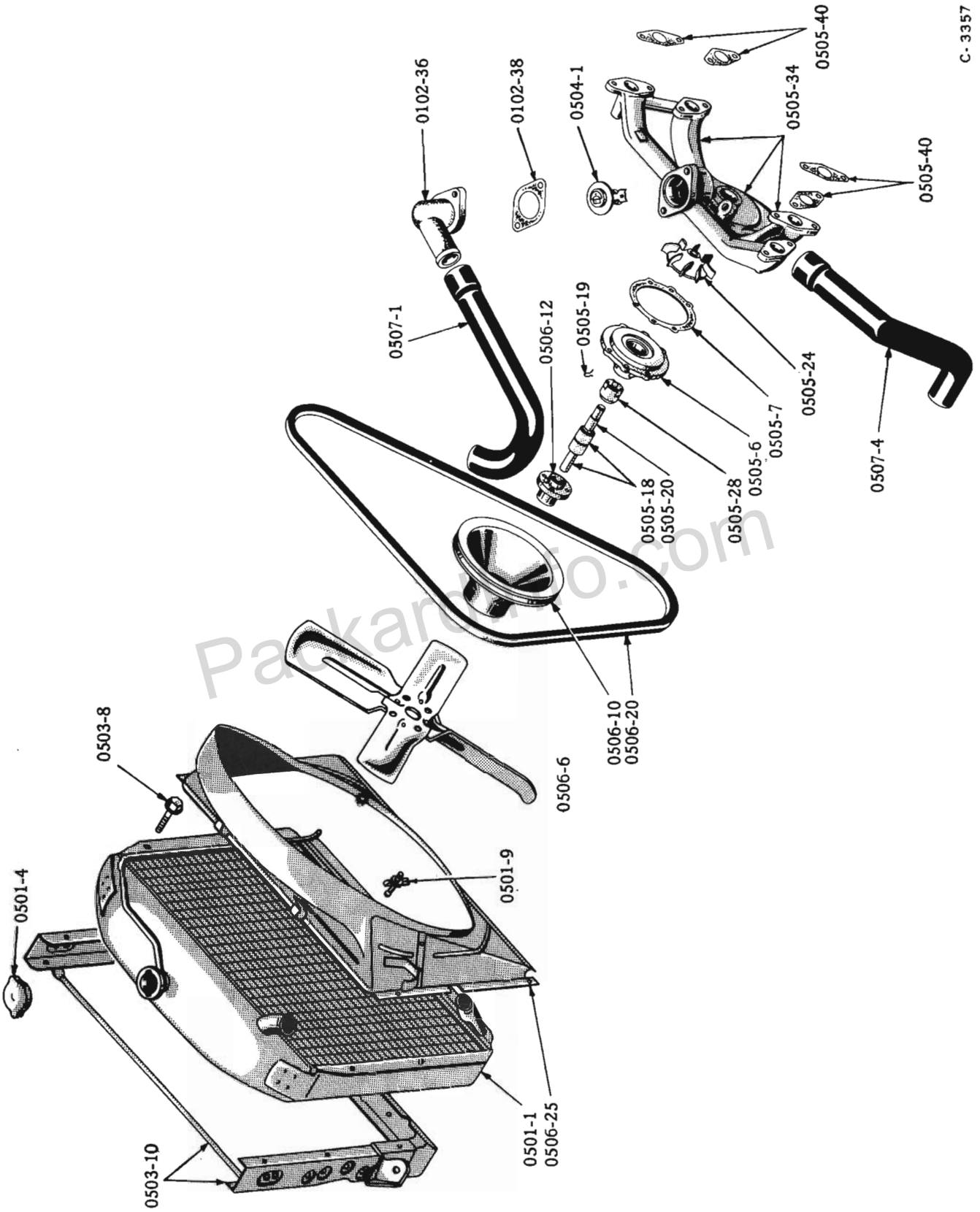

C-3357

RADIATOR, FAN and WATER PUMP Model 56J

COOLING

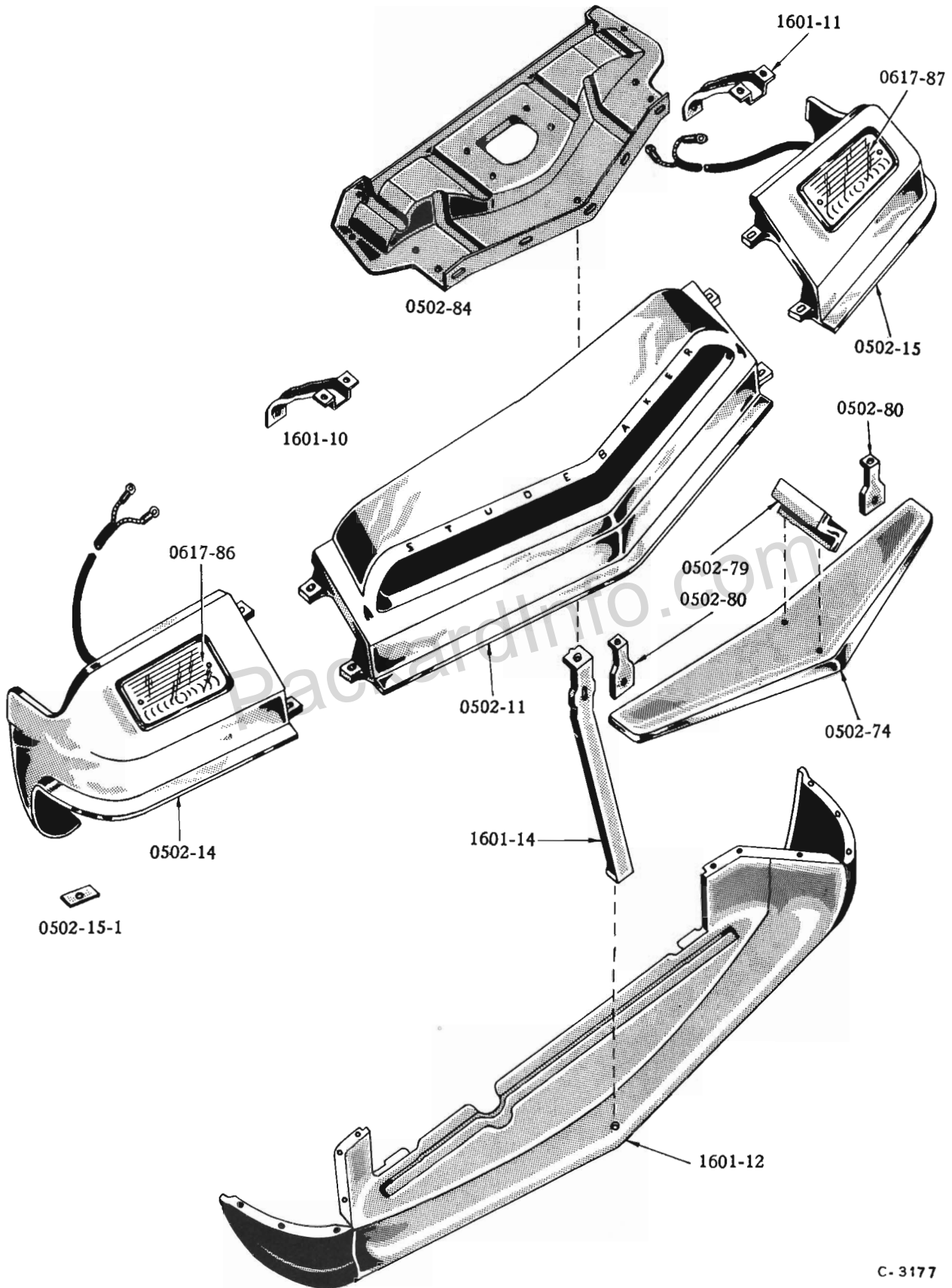

C-3177

RADIATOR GRILLE - Models 16G, 6H (W-F-Y-D)

COOLING

Plate 05-5

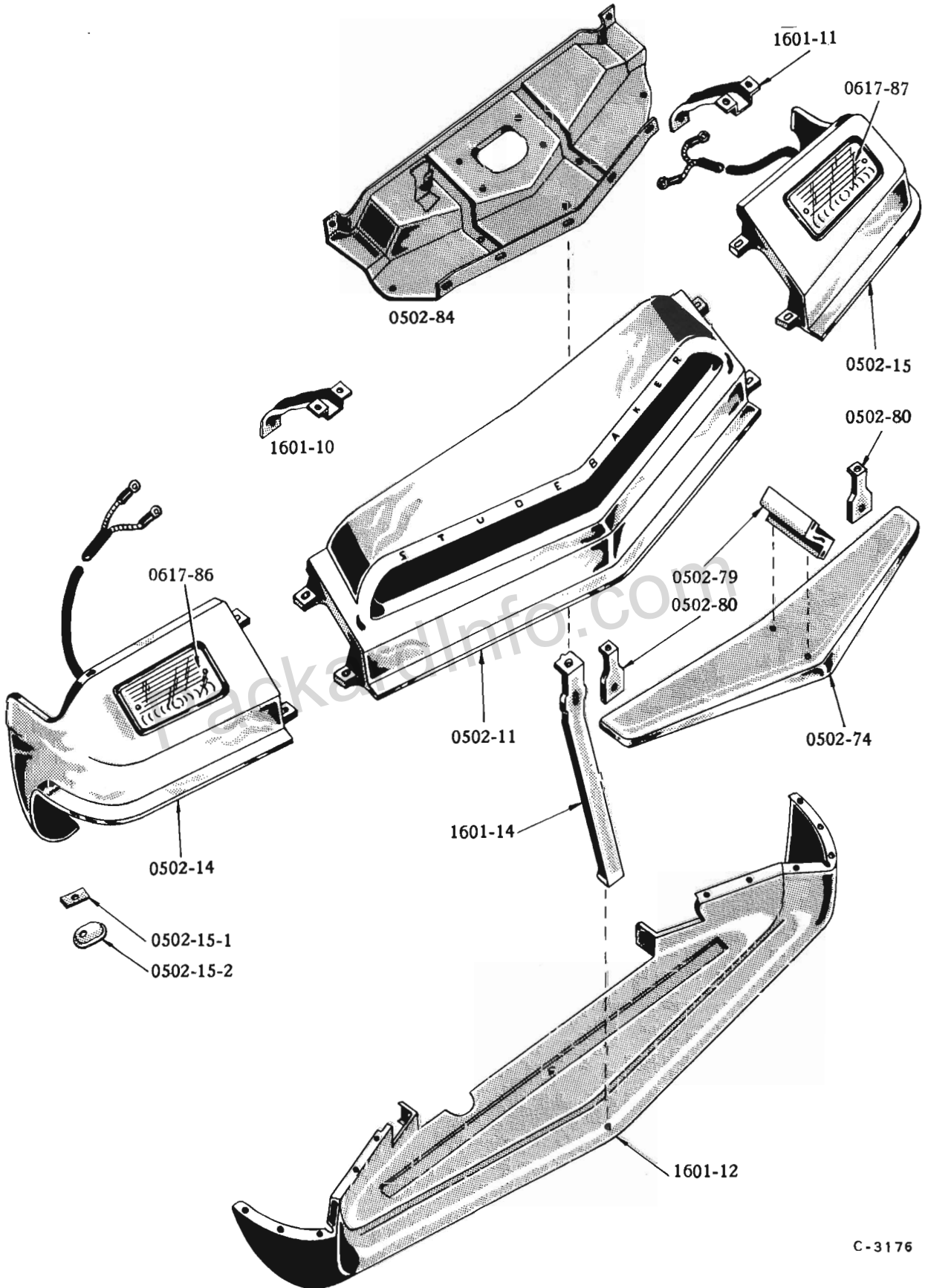

C-3176

RADIATOR GRILLE - Models 16G, 6H (C-K)

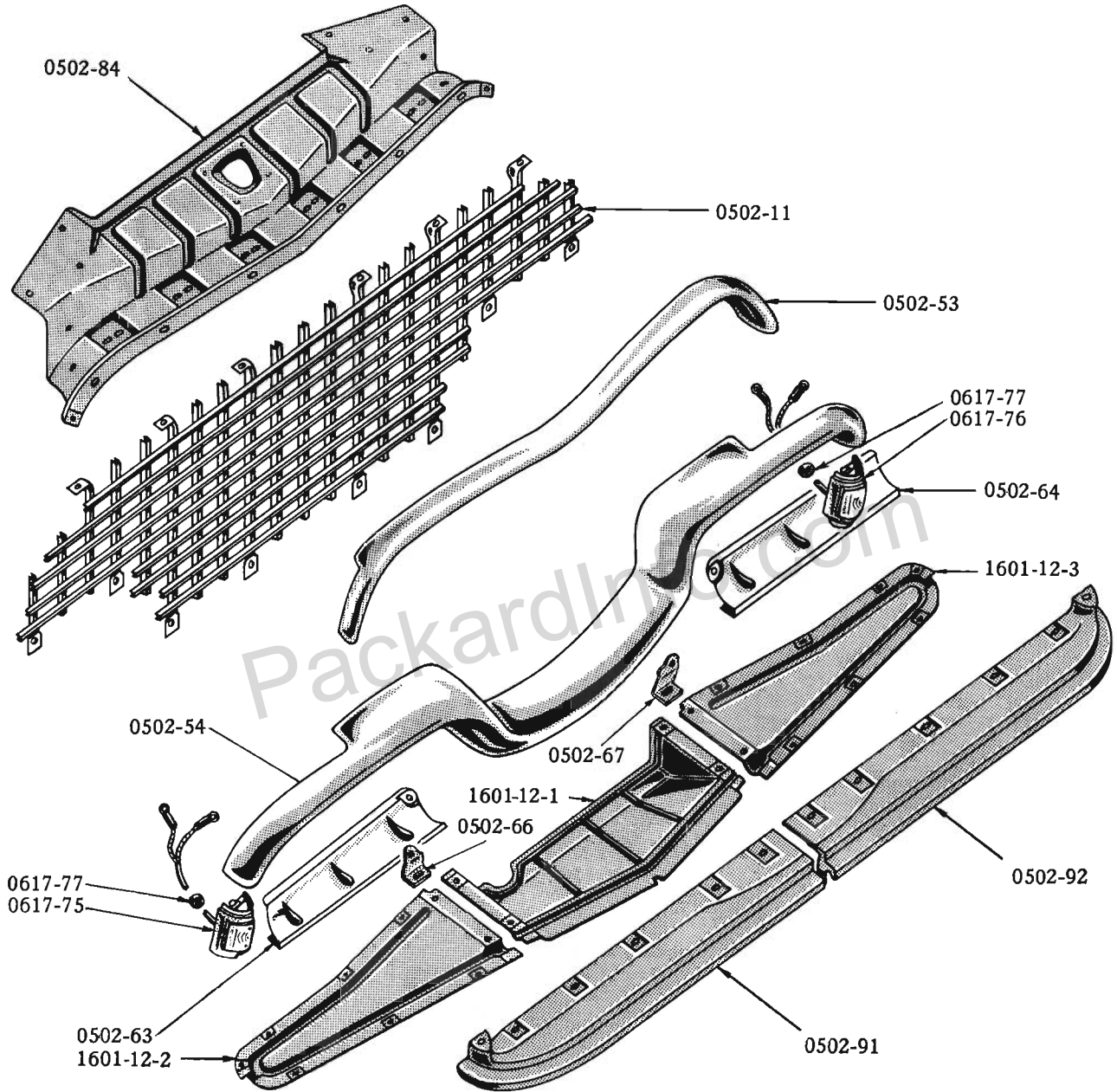

C-3335

RADIATOR GRILLE - Models 56G, 56B, 56H (W-F-Y-D)

COOLING

Plate 05-7

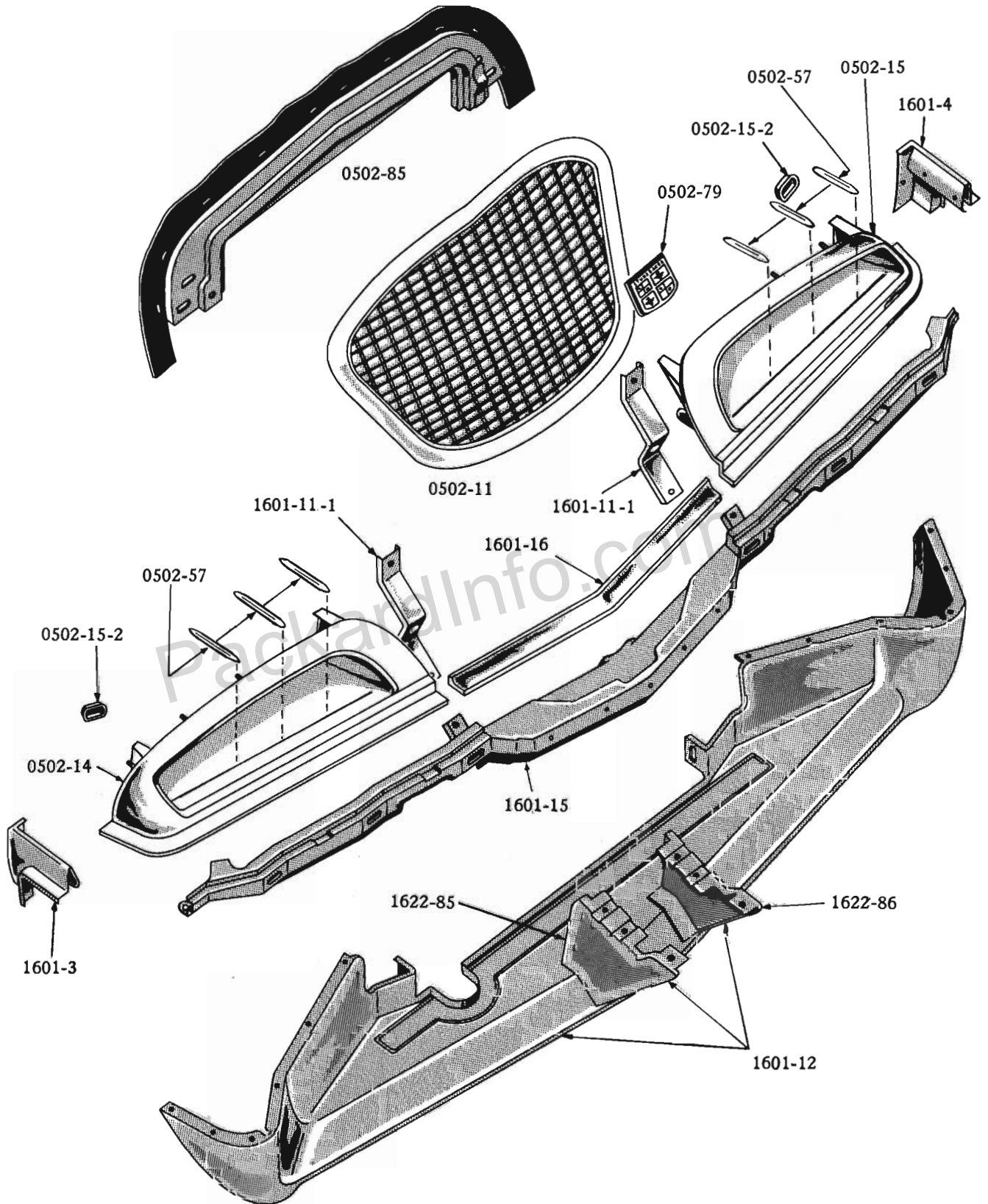

**RADIATOR GRILLE - Models 56G, 56B, 56H, 56J,
57G 57B, 57H, (CK)**

C-3363

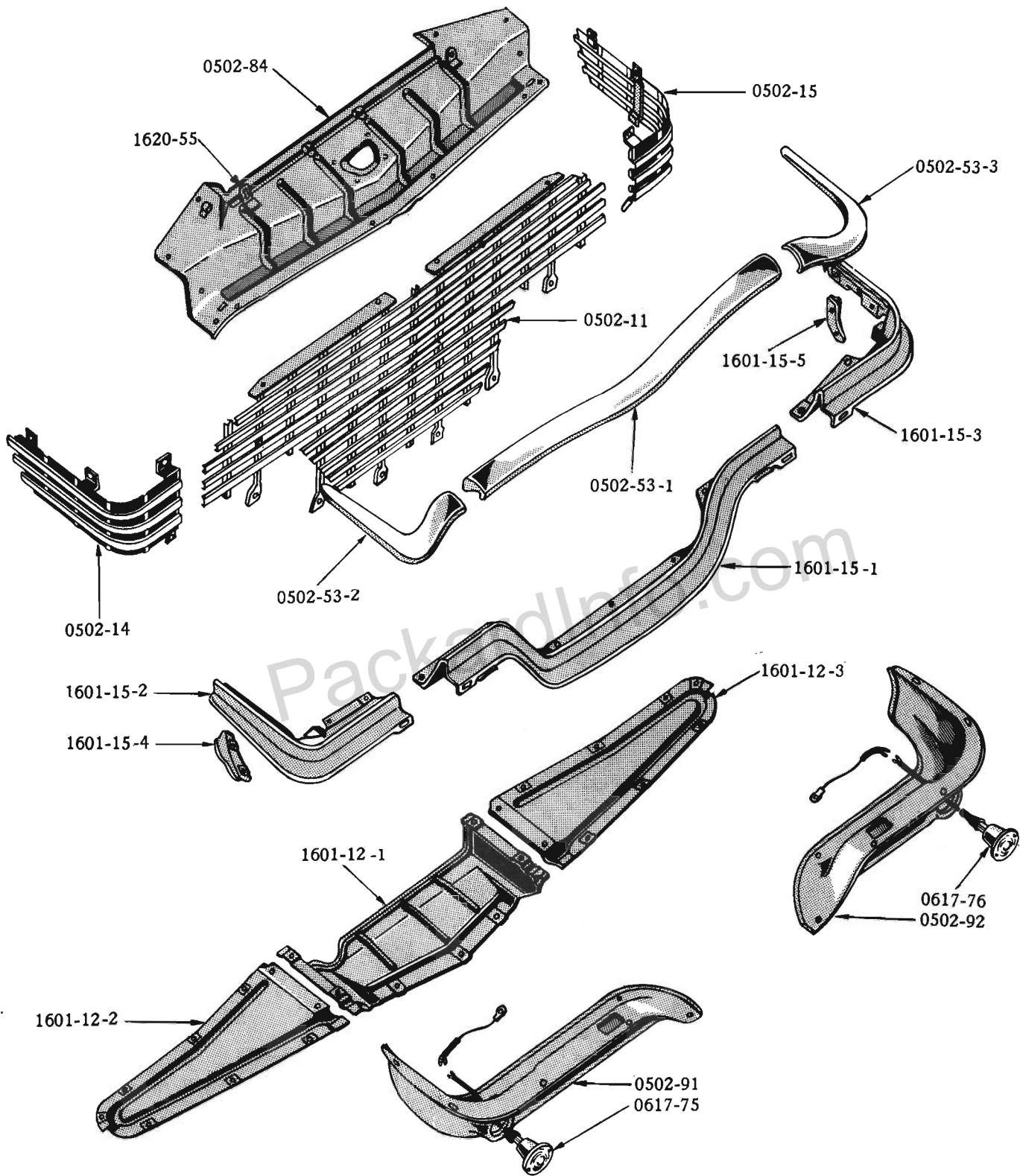

C-3464

RADIATOR GRILLE - Models 57G, 57B, 57H, (W-F-D-P-Y)

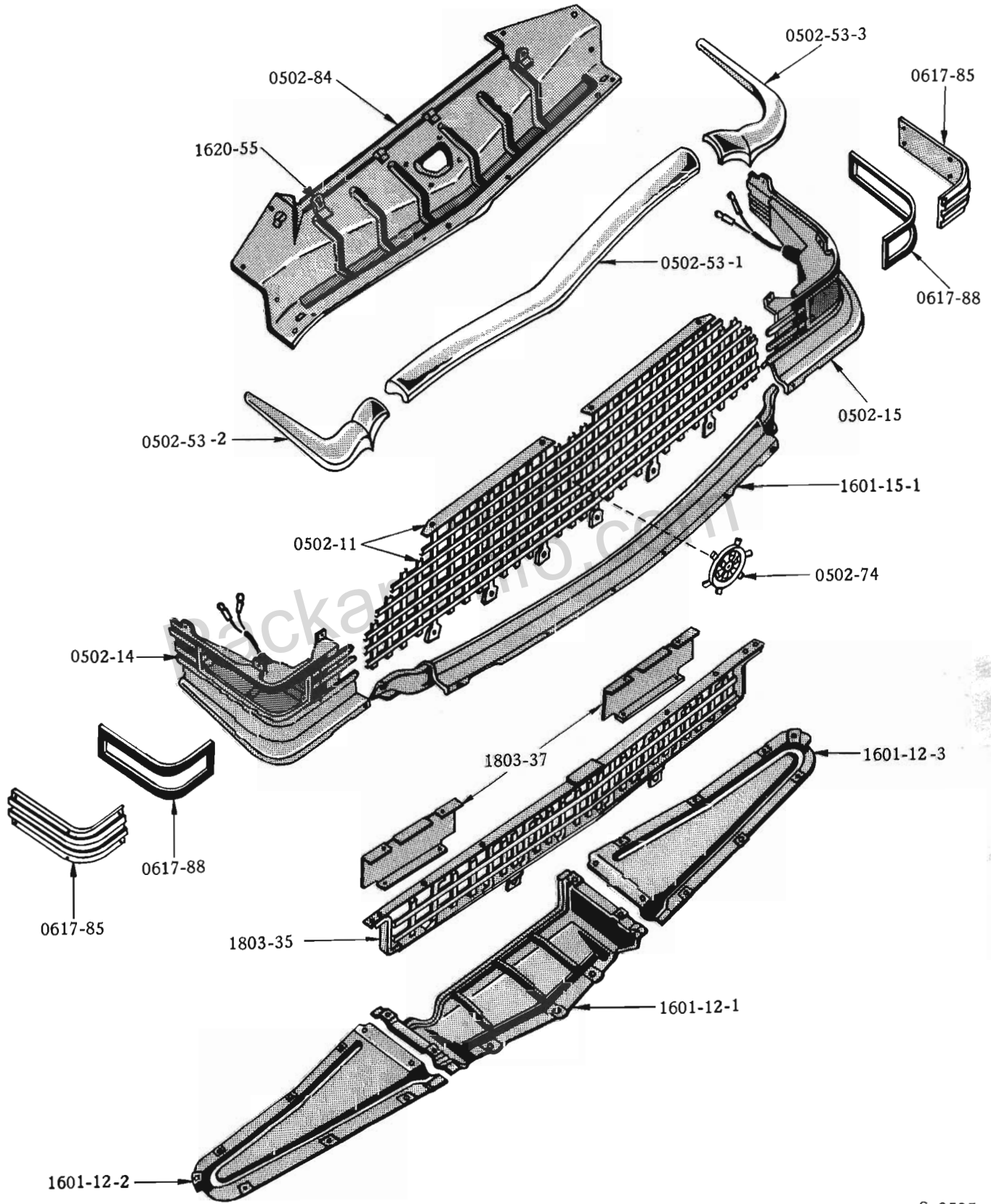

RADIATOR GRILLE - Model 57L

C-3505

COOLING

ILLUST. NUMBER	PART NUMBER	CHANGE	DESCRIPTION	MODELS	PER CAR
0501- RADIATOR CORE AND FILLER CAP (Plates 05-1, 2, 3)					
	AC-2182		CLEANER KIT, RADIATOR AND WATER (CONSISTS OF CLEANER, BRACKET, CONNECTING AND FASTENING PARTS)	ALL MODELS	1
	AC-2183		CARTRIDGE KIT, RADIATOR AND WATER CLEANER (CONSISTS OF CARTRIDGE AND GASKET)	ALL MODELS	1
0501-1	536463		CORE, RADIATOR	16G6	1
0501-1	533784		CORE, RADIATOR - LHC - NOTE 1	16G8	1
0501-1	536464		CORE, RADIATOR - LHC - NOTE 2	16G8, 6H.	1
	536465		CORE, RADIATOR - RHC	16G8, 6H.	1
0501-1	1539060		CORE, RADIATOR - W-F-D } NOTE 3	56G, 57G.	1
0501-1	1539071		CORE, RADIATOR - C-K. }	56G, 57G.	1
0501-1	1543110		CORE, RADIATOR - W-F-D, P. } NOTE 4	57G.	1
0501-1	1543111		CORE, RADIATOR - C-K. }	57G.	1
0501-1	1539061		CORE, RADIATOR - W-F-D-P-Y- LHC } NOTE 3	56B, 56H, 57B, 57H.	1
0501-1	1539072		CORE, RADIATOR - C-K - LHC }	56B, 56H, 57B.	1
0501-1	1539062		CORE, RADIATOR - RHC }	56B, 56H, 57B, 57H.	1
0501-1	1543112		CORE, RADIATOR - W-F-D-P-Y-LHC } NOTE 4	57B, 57H.	1
0501-1	1543113		CORE, RADIATOR - C-K-LHC }	57B.	1
0501-1	1543114		CORE, RADIATOR - RHC }	57B, 57H.	1
0501-1	1539072		CORE, RADIATOR - C-K3 - NOTE 3.	57H.	1
0501-1	1543113		CORE, RADIATOR - C-K3 - NOTE 4.	57H.	1
0501-1	1542859		CORE, RADIATOR - W/OD. - LHC - K7 - NOTE 3	57H.	1
0501-1	1543116		CORE, RADIATOR - W/OD. - LHC - K7 - NOTE 4	57H.	1
0501-1	1542858		CORE, RADIATOR - W/AD. - LHC - K7 - NOTE 3	57H.	1
0501-1	1543115		CORE, RADIATOR - W/AD. - LHC - K7 - NOTE 4	57H.	1
0501-1	1543644		CORE, RADIATOR - W/OD. - LHC	57L.	1
0501-1	1543647		CORE, RADIATOR - W/OD. - RHC	57L.	1
0501-1	1543643		CORE, RADIATOR - W/AD. - LHC	57L.	1
0501-1	1543646		CORE, RADIATOR - W/AD. - RHC	57L.	1
0501-1	1539094		CORE, RADIATOR - W/AD.	56J.	1
0501-1	1539095		CORE, RADIATOR - W/OD.	56J.	1
(SEE GROUP 0503 FOR MOUNTINGS)					
0501-4	536502		CAP, RADIATOR FILLER - 13 LBS. PRESSURE	ALL EXCEPT 16G8.	1
0501-4	531826		CAP, RADIATOR FILLER - 7 LBS. PRESSURE (FOR 533784 CORE)	16G8	1
0501-4	536502		CAP, RADIATOR FILLER - 13 LBS. PRESSURE (FOR 536464-5 CORE)	16G8	1
0501-9	2075X1		COCK, RADIATOR DRAIN - NOTE 3	ALL MODELS	1
0501-9	G148344		COCK, RADIATOR DRAIN - NOTE 4	57G, 57B, 57H, 57L.	1
0502- RADIATOR GRILLE (Plates 05-4 thru 9)					
0502-11	308071W 1501X30		GRILLE, RADIATOR CENTER	16G, 6H	1
			SCREW, TO UPPER AND SIDE AIR DEFLECTOR 5/16"-18X5/8"	16G, 6H	7
	G446363		WASHER, PLAIN 5/16"	16G, 6H	7
0502-11	1312470 1960X2		GRILLE, RADIATOR - W-F-D-Y.	56G, 56B, 56H.	1
			SCREW AND WASHER, TO UPPER AIR DEFLECTOR 1/4"-20X5/8"	56G, 56B, 56H.	6
	1578X2		SPEED NUT 1/4".	56G, 56B, 56H.	6

NOTES	1 - USED ON MODEL 16G8 BEFORE CAR SERIALS	SO. BEND 8,386,706	CANADA 8,958,382		
	2 - USED ON AND AFTER CAR SERIALS IN NOTE 1.				
	3 - USED ON MODELS BEFORE CAR SERIALS	57G G-1,387,236	57B ----	57H ----	57H-K7 6,102,031 W/OD.
		C-K G-1,386,066	----	----	
4 - USED ON AND AFTER CAR SERIALS IN NOTE 3					

COOLING

0502

ILLUST. NUMBER	PART NUMBER	CHANGE ✓	DESCRIPTION	MODELS	PER CAR
0502- RADIATOR GRILLE (Plates 05-4 thru 9)					
0502-11	1320376		GRILLE, RADIATOR CENTER -W-F-D-P-Y	57G, 57B, 57H	1
	2043X9		SCREW, TO AIR DEFLECTOR AND GUARD 1/4"X1/2"	57G, 57B, 57H	10
	1578X36		SPEED NUT, 1/4"	57G, 57B, 57H	10
0502-11	1323125		GRILLE, RADIATOR CENTER	57L	1
	2043X9		SCREW, TO AIR DEFLECTOR 1/4"X1/2"	57L	4
	1578X38		SPEED NUT, 1/4"	57L	4
	1960X5		SCREW AND WASHER, TO BUMPER PANEL	57L	6
	1578X2		SPEED NUT	57L	6
0502-11	1312189		GRILLE, RADIATOR CENTER (IN HOOD) C-K	56G, 56B, 56H, 56J, 57G, 57B, 57H	1
	1959X4		STUD, TO HOOD 1/4"-20X1"	56G, 56B, 56H, 56J, 57G, 57B, 57H	10
	G271172		NUT AND WASHER 1/4"-20	56G, 56B, 56H, 56J, 57G, 57B, 57H	10
	286845		STOOL, SPECIAL	56G, 56B, 56H, 56J, 57G, 57B, 57H	10
0502-14	309428W		GRILLE, RIGHT, RADIATOR SIDE } W-F } INCLS. PARKING AND.	16G, 6H	1
0502-15	309429W			GRILLE, LEFT, RADIATOR SIDE } Y-D } DIRECTIONAL LAMP	16G, 6H
0502-14	309432W		GRILLE, RIGHT, RADIATOR SIDE } C-K } CABLES BUT LESS	16G, 6H	1
0502-15	309433W		GRILLE, LEFT, RADIATOR SIDE } } BULB AND LENS	16G, 6H	1
	1959X4		STUD, TO FENDER 1/4"-20X1" - W-F-D-Y	16G, 6H	4
	1959X4		STUD, TO FENDER 1/4"-20X1" - C-K	16G, 6H	6
	G271172		NUT AND WASHER, HEX. 1/4"-20	16G, 6H	*
0502-15-1	308062		WASHER, SPECIAL 1/4"	16G, 6H	*
0502-15-2	308138		STOOL, SPECIAL - C-K	16G, 6H	4
	1501X30		SCREW, TO FENDER AND PANEL 5/16"-18X5/8"	16G, 6H	6
	1501X38		SCREW, TO CENTER GRILL 5/8"-18X1 1/8"	16G, 6H	4
	G446363		WASHER, PLAIN 5/16"	16G, 6H	10
	311022		SPACER	16G, 6H	*
	2067X4		SCREW, TO LOWER PANEL BRACKET 5/16"-18X3/4" - C-K	16G, 6H	2
	1578X23		SPEED NUT 5/16"-18	16G, 6H	2
	310241		SPACER	16G, 6H	*
0502-14	1312030		GRILLE, RIGHT, RADIATOR SIDE - C-K	56G, 56B, 56H, 56J, 57G, 57B, 57H	1
0502-15	1312031		GRILLE, LEFT, RADIATOR SIDE - C-K	56G, 56B, 56H, 56J, 57G, 57B, 57H	1
	1959X4		STUD, TO FENDER 1/4"-20X1"	56G, 56B, 56H, 56J, 57G, 57B, 57H	6
	1959X10		STUD, TO FENDER 5/16"-18X1 1/4"	56G, 56B, 56H, 56J, 57G, 57B, 57H	2
	1959X10		STUD, TO AIR INTAKE PANEL AND BRACE. 5/16"-18X1 1/4"	56G, 56B, 56H, 56J, 57G, 57B, 57H	6
	1959X11		STUD, TO AIR INTAKE PANEL 5/16"-18X1 3/4"	56G, 56B, 56H, 56J, 57G, 57B, 57H	2
	G271172		NUT AND WASHER, HEX. 1/4"-20	56G, 56B, 56H, 56J, 57G, 57B, 57H	6
	G271184		NUT AND WASHER, HEX. 5/16"-18	56G, 56B, 56H, 56J, 57G, 57B, 57H	10
	G446470		WASHER, PLAIN 3/8"	56G, 56B, 56H, 56J, 57G, 57B, 57H	2
	G446363		WASHER, PLAIN	56G, 56B, 56H, 56J, 57G, 57B, 57H	8
	308062		WASHER, SPECIAL (FOR 1959X4 STUD)	56G, 56B, 56H, 56J, 57G, 57B, 57H	6
0502-15-2	308138		STOOL, TO FENDER 5/16" STUD	56G, 56B, 56H, 56J, 57G, 57B, 57H	2
0502-14	1320378		GRILLE, RIGHT, RADIATOR SIDE } W-F-D-P-Y	57G, 57B, 57H	1
0502-15	1320379		GRILLE, LEFT, RADIATOR SIDE }	57G, 57B, 57H	1
	2043X10		SCREW, TO FENDER AND GUARD 1/4"X1/2"	57G, 57B, 57H	8
	1578X37		SPEED NUT, 1/4"	57G, 57B, 57H	8
0502-14	1323126		GRILLE, RIGHT, RADIATOR SIDE } INCLS. PARKING LAMP	57L	1
0502-15	1323127		GRILLE, LEFT, RADIATOR SIDE } SOCKET AND CABLE	57L	1
	1959X15		STUD, TO FENDER	57L	2
	G271172		NUT AND WASHER, HEX. 1/4"-20	57L	2
	41X580		WASHER, PLAIN 1/4"	57L	2
	G171026		SCREW, TO FENDER AND PANEL 1/4"-20X1/2"	57L	12
	G120392		WASHER, PLAIN 9/32"	57L	12
0502-53	1312460W		MOULDING, RADIATOR GRILLE UPPER - W-F-D-Y	56G, 56B, 56H	1
	1501X35		SCREW, TO UPPER AIR DEFLECTOR AND FENDER - 1/4"-20X5/8"	56G, 56B, 56H	8
	G120386		WASHER, PLAIN 5/16"	56G, 56B, 56H	8

NOTE { * - USE AS REQUIRED.

COOLING

ILLUST. NUMBER	PART NUMBER	CHANGE	DESCRIPTION	MODELS	PER CAR
0502- RADIATOR GRILLE-Cont'd, (Plates 05-4 thru 9)					
0502-53-1	132009W		MOULDING, CENTER, RADIATOR GRILLE - W-F-D-P-Y (ON HOOD)	57G, 57B, 57H, 57L	1
0502-53-2	1320058		MOULDING, RIGHT, RADIATOR GRILLE W-F-D-P-Y } ON	57G, 57B, 57H	1
0502-53-3	1320059		MOULDING, LEFT, RADIATOR GRILLE W-F-D-P-Y } FENDERS	57G, 57B, 57H	1
0502-53-2	1323044		MOULDING, RIGHT, RADIATOR GRILLE } ON	57L	1
0502-53-3	1323045		MOULDING LEFT, RADIATOR GRILLE } FENDERS	57L	1
	2043X6		SCREW AND WASHER, TO HOOD 5/16"x3/4"	57G, 57B, 57H, 57L	1
	2043X7		SCREW AND WASHER, TO HOOD 5/16"x1 5/8"	57G, 57B, 57H, 57L	4
	1959X13		STUD, TO FENDER 5/16"x18X1"	57G, 57B, 57H, 57L	6
	G271184		NUT AND WASHER, HEX. 5/16"-18	57G, 57B, 57H, 57L	6
	41X184		WASHER, PLAIN 5/16"	57G, 57B, 57H, 57L	6
0502-54	1312462W		MOULDING, RADIATOR GRILLE LOWER - W-F-D-Y	56G, 56B, 56H	1
	1501X35		SCREW, TO GRILLE 1/4"x20X5/8"	56G, 56B, 56H	8
	G120392		WASHER, PLAIN 9/32"	56G, 56B, 56H	8
	1501X30		SCREW, TO FENDER 5/16"x18X5/8"	56G, 56B, 56H	4
	G446470		WASHER, PLAIN 3/8"	56G, 56B, 56H	4
0502-57	1321161		MOULDING, RADIATOR SIDE GRILLE BEAD - K7.	57H	6
	1320595		CLIP, TO INNER GRILLE	57H	12
0502-63	1312844		SCOOP, RIGHT, RADIATOR GRILLE OPENING AIR - W-F-D-Y	56G, 56B, 56H	1
0502-64	1312845		SCOOP, LEFT, RADIATOR GRILLE OPENING AIR - W-F-D-Y	56G, 56B, 56H	1
	1957X4		SCREW, TO BRACKET 5/16"x10X7/8"	56G, 56B, 56H	2
	1578X25		SPEED NUT 5/16"	56G, 56B, 56H	2
0502-66	1316224		BRACKET, RIGHT, AIR SCOOP TO LOWER PANEL } W-F-D-Y	56G, 56B, 56H	1
0502-67	1316225		BRACKET, LEFT, AIR SCOOP TO LOWER PANEL }	56G, 56B, 56H	1
0502-74	308701WP		ORNAMENT, RADIATOR CENTER GRILLE.	16G, 6H.	1
	1501X35		SCREW, TO GRILLE 1/4"x20X5/8"	16G, 6H.	3
0502-74	1323315VP		ORNAMENT, RADIATOR GRILLE	57L	1
	1323318		CLIP, TO GRILLE	57L	2
	G446119		SCREW AND WASHER, TO GRILLE No. 8 X 9/16"	57L	2
0502-79	308092VP		" S " EMBLEM, RADIATOR CENTER GRILLE ORNAMENT.	16G, 6H.	1
	1501X33		SCREW, TO ORNAMENT 1/4"x20X1/2"	16G, 6H.	2
	1501X30		SCREW, TO BRACE 5/16"x18X5/8"	16G, 6H.	1
	G446363		WASHER, PLAIN 5/16"	16G, 6H.	1
0502-79	1314307		EMBLEM, RADIATOR GRILLE - C-K	56G, 56B, 56H, 56J, 57G, 57B, 57H	1
	G271166		NUT AND WASHER, TO GRILLE No. 10-24.	56G, 56B, 56H, 56J, 57G, 57B, 57H	1
	41X555		WASHER, PLAIN	56G, 56B, 56H, 56J, 57G, 57B, 57H	1
	1314479		LOCATOR	56G, 56B, 56H, 56J, 57G, 57B, 57H	1
0502-80	308702P		BRACE, ORNAMENT TO UPPER AIR DEFLECTOR.	16G, 6H.	2
	1501X30		SCREW, TO ORNAMENT 5/16"x18X5/8"	16G, 6H.	2
	G446363		WASHER, PLAIN 5/16"	16G, 6H.	2
	1957X2		SCREW AND WASHER, TO AIR DEFLECTOR 5/16"x10X3/4"	16G, 6H.	2
	1578X27		SPEED NUT 5/16"	16G, 6H.	2
0502-84	308093		AIR DEFLECTOR, RADIATOR UPPER - W-F-D-Y	16G, 6H.	1
0502-84	308223		AIR DEFLECTOR, RADIATOR UPPER - C-K	16G, 6H.	1
	G443945		SCREW TO CORE SUPPORT 5/16"x18X1"	16G, 6H.	2
	1905X14		SCREW AND WASHER, TO FENDER 5/16"x18X3/4" - W-F-D-Y	16G, 6H.	6
	1905X14		SCREW AND WASHER, TO FENDER 5/16"x18X3/4" - C-K.	16G, 6H.	2
0502-84	1312925		AIR DEFLECTOR, RADIATOR UPPER - W-F-D-Y	56G, 56B, 56H	1
0502-84	1320063		AIR DEFLECTOR, RADIATOR UPPER - W-F-D-P-Y	57G, 57B, 57H, 57L	1
	1957X4		SCREW AND WASHER, TO FENDER 5/16"x10X7/8"	ALL EXCEPT 16G, 6H, 56J	6
	1578X27		SPEED NUT 5/16"	ALL EXCEPT 16G, 6H, 56J	6
0502-85	1312475		BAFFLE AND SEAL, RADIATOR UPPER AIR - C-K	56G, 56B, 56H, 56J, 57G, 57B, 57H	1
	1905X14		SCREW AND WASHER, TO FENDER	ALL EXCEPT 16G, 6H, 57L	4

COOLING

0505

ILLUST. NUMBER	PART NUMBER	CHANGE	DESCRIPTION	MODELS	PER CAR
0502- RADIATOR GRILLE-Cont'd. (Plates 05-4 thru 9)					
0502-91	1312840		SPLASHGUARD, RIGHT, RADIATOR GRILLE TO BUMPER - W-F-D-Y	56G, 56B, 56H	1
0502-92	1312841		SPLASHGUARD, LEFT, RADIATOR GRILLE TO BUMPER - W-F-D-Y	56G, 56B, 56H	1
	1957X4		SCREW AND WASHER, TO LOWER MOULDING AND AIR SCOOP 5/16" X7/8"	56G, 56B, 56H	10
	1578X25		SPEED NUT 5/16"	56G, 56B, 56H	10
	1501X33		SCREW, TO SIGNAL LAMP HOUSING 1/4"X1/2"	56G, 56B, 56H	2
	G120386		WASHER, PLAIN 5/16"	56G, 56B, 56H	2
	1960X2		SCREW AND WASHER, RIGHT TO LEFT GUARD 1/4" X5/8"	56G, 56B, 56H	1
	1578X2		SPEED NUT 1/4"	56G, 56B, 56H	1
0502-91	1320074		SPLASHGUARD, RIGHT, GRILLE TO BUMPER	} W-F-D-P-Y. 57G, 57B, 57H 57G, 57B, 57H 57G, 57B, 57H 57G, 57B, 57H	1
0502-92	1320075		SPLASHGUARD, LEFT, GRILLE TO BUMPER		1
	3035X1		SCREW, TO BUMPER 1/4"-14X5/8"		10
	1578X36		SPEED NUT 1/4"		10
0503- RADIATOR MOUNTINGS (Plates 05-1, 2, 3)					
0503-8	G456643		SCREW, CORE TO SUPPORT 5/16"-18X3/4"	ALL MODELS	6
0503-10	298385		SUPPORT, RADIATOR CORE - W-F-D-Y	16G, 6H	1
0503-10	303446		SUPPORT, RADIATOR CORE - C-K	16G, 6H	1
0503-10	1312069		SUPPORT, RADIATOR CORE - W-F-D-Y-P	56G, 56B, 56H, 57G, 57B, 57H, 57L	1
0503-10	1312081		SUPPORT, RADIATOR CORE - C-K	56G, 56B, 56H, 56J, 57G, 57B, 57H	1
	304703		SPACER, SUPPORT - C-K	ALL MODELS	2
	293686		BOLT, TO FRAME 3/8"-24X4 3/4"	ALL MODELS	2
	G120369		NUT, HEX. 3/8"-24	ALL MODELS	2
	41X557		WASHER, PLAIN 3/8"	ALL MODELS	*
	G120382		WASHER, LOCK 3/8"	ALL MODELS	2
0504- THERMOSTAT (Plates 05-1, 2, 3)					
0504-1	440066		THERMOSTAT, ENGINE - STD. (OPENS AT 170°)	16G6, 56G, 56J, 57G	1
0504-1	531470		THERMOSTAT, ENGINE - LOW (OPENS AT 160°)	16G6, 56G, 56J, 57G	1
0504-1	532017		THERMOSTAT, ENGINE - HIGH (OPENS AT 180°)	16G6, 56G, 56J, 57G	1
0504-1	1540787		THERMOSTAT, ENGINE - STD. (OPENS AT 170°)	16G8, 6H, 56B, 56H, 57B, 57H, 57L	1
0504-1	533247		THERMOSTAT, ENGINE - LOW (OPENS AT 160°)	16G8, 6H, 56B, 56H, 57B, 57H, 57L	1
0504-1	533257		THERMOSTAT, ENGINE - HIGH (OPENS AT 180°)	16G8, 6H, 56B, 56H, 57B, 57H, 57L	1
0504-4	196709		SPACER, THERMOSTAT	16G6, 56G, 57G	1
0504-5	194658		GASKET, GARLOCK (INCL. IN 536557 SET)	16G6, 56G, 57G	1
0505- WATER PUMP (Plates 05-1, 2, 3)					
0505-1	534714		WATER PUMP AND FAN HUB. (ILLUST. PLATE 01-5)	16G6, 56G, 57G	1
0505-4	195674		STUD, TO CYL. BLOCK THRU GENERATOR ARM 5/16"-18-24X1 21/32"	16G6, 56G, 57G	1
	G180084		SCREW, TO CYL. BLOCK 5/16"-18X1 5/8"	16G6, 56G, 57G	1
	G180078		SCREW, TO CYL. BLOCK 5/16"-18X7/8"	16G6, 56G, 57G	1
	G120393		WASHER, PLAIN 11/32"	16G6, 56G, 57G	1
	G138485		WASHER, LOCK 5/16"	16G6, 56G, 57G	3
0505-1	531169		WATER PUMP AND FAN HUB. (ILLUST. PLATE 01-7)	16G8, 6H, 56B, 56H, 57B, 57H, 57L	1
	G179814		SCREW, TO WATER MANIFOLD 5/16"-18X1"	16G8, 6H, 56B, 56H, 57B, 57H, 57L	4
	156768		GASKET, ANNULAR	16G8, 6H, 56B, 56H, 57B, 57H, 57L	4
0505-1	458410		WATER PUMP AND FAN HUB. (ILLUST. PLATE 01-9)	56J	1
	G106324		SCREW, TO WATER MANIFOLD 5/16"-18X5/8"	56J	6
	354310		WASHER, LOCK 5/16"	56J	6

NOTE { * USE AS REQUIRED.

COOLING

ILLUST. NUMBER	PART NUMBER	CHANGE	DESCRIPTION	MODELS	PER CAR
0505- WATER PUMP-Cont'd. (Plates 05-1, 2, 3)					
	535943		WATER PUMP REPAIR KIT - CONSISTS OF: 1-534722 SHAFT AND BEARING 1-194202 LOCK RING 1-199655 IMPELLER 1-534597 BODY GASKET 1-515112 FAN HUB	16G6, 56G, 57G.	1
	531171		WATER PUMP REPAIR KIT - CONSISTS OF: 1-527244 SHAFT AND BEARING 1-194202 LOCK RING 1-530261 IMPELLER 1-527246 COVER GASKET 1-515112 FAN HUB	16G8, 6H, 56B, 56H, 57B, 57H, 57L	1
0505-6	----		BODY, WATER PUMP (USE 534714 PUMP)	16G6, 56G, 57G.	1
	G103879		PLUG, PIPE 3/8"	16G6, 56G, 57G.	1
0505-6	----		COVER, WATER PUMP (USE 531169 PUMP).	16G8, 6H, 56B, 56H, 57B, 57H, 57L	1
0505-6	440050		COVER, WATER PUMP	56J	1
0505-7	534597		GASKET, WATER PUMP BODY.	16G6, 56G, 57G.	1
0505-7	527246		GASKET, WATER PUMP COVER	16G8, 6H, 56B, 56H, 57B, 57H, 57L	1
0505-7	440062		GASKET, WATER PUMP COVER	56J	1
0505-18	534722		SHAFT AND BEARING, WATER PUMP.	16G6, 56G, 57G.	1
0505-18	527244		SHAFT AND BEARING, WATER PUMP.	16G8, 6H, 56B, 56H, 57B, 57H, 57L	1
0505-18	426431		SHAFT AND BEARING, WATER PUMP.	56J	1
0505-19	194202		LOCK RING	ALL EXCEPT 56J.	1
0505-19	412404		LOCK RING	56J	1
0505-20	196327		SLINGER, WATER PUMP SHAFT.	16G6, 56G, 57G.	1
0505-20	530280		SLINGER, WATER PUMP SHAFT.	16G8, 6H, 56B, 56H, 57B, 57H, 57L	1
0505-20	412489		SLINGER, WATER PUMP SHAFT.	56J	1
0505-24	1541337		IMPELLER, WATER PUMP	16G6, 56G, 57G.	1
0505-24	530261		IMPELLER, WATER PUMP	16G8, 6H, 56B, 56H, 57B, 57H, 57L	1
0505-24	440566		IMPELLER, WATER PUMP	56J	1
0505-26	199512		WASHER, WATER PUMP IMPELLER CARBON	16G6, 56G, 57G	1
0505-28	426059		SEAL, WATER PUMP	56J	1
0505-34	536113		MANIFOLD w/PLUGS, WATER.	16G8, 6H, 56B, 56H, 57B, 57H, 57L	1
	G103879		PLUG, PIPE 3/8"	16G8, 6H, 56B, 56H, 57B, 57H, 57L	2
0505-37	527255		STUD, TO HEAD THRU GENERATOR ARM 5/16"-18-24X2 11/16"	16G8, 6H, 56B, 56H, 57B, 57H, 57L	1
	G179826		SCREW, TO CYL. BLOCK THRU GROUND STRAP 5/16"-18X2"	16G8, 6H, 56B, 56H, 57B, 57H, 57L	1
	G180085		SCREW, TO CYL. BLOCK 5/16"-18X1 3/4"	16G8, 6H, 56B, 56H, 57B, 57H, 57L	3
	G180078		SCREW, TO HEAD 5/16"-18X1"	16G8, 6H, 56B, 56H, 57B, 57H, 57L	3
	G120393		WASHER, PLAIN 5/16"	16G8, 6H, 56B, 56H, 57B, 57H, 57L	5
	G120214		WASHER, LOCK 5/16"	16G8, 6H, 56B, 56H, 57B, 57H, 57L	8
0505-34	440386		MANIFOLD w/PLUGS, WATER	56J	1
	G103879		PLUG, PIPE 3/8"	56J	1
	440075		PLUG, CORE HOLE 1 3/8"	56J	1
	G106331		SCREW, TO CYL. BLOCK 3/8"-16X1 1/8"	56J	8
	G120382		WASHER, LOCK 3/8"	56J	8
0505-40	527240		GASKET, UPPER, WATER MANIFOLD } INCL. IN	16G8, 6H, 56B, 56H, 57B, 57H, 57L	2
0505-42	527856		GASKET, LOWER, WATER MANIFOLD } 536265 SET	16G8, 6H, 56B, 56H, 57B, 57H, 57L	2
0505-40	440333		GASKET, WATER MANIFOLD (INCL. IN 458670 SET)	56J	4

COOLING

0506

ILLUST. NUMBER	PART NUMBER	CHANGE	DESCRIPTION	MODELS	PER CAR
0506 FAN AND BELT (Plates 05-1, 2, 3)					
0506-6	534736P		BLADES, FAN - 4 BLADES	16G6,56G,57G	1
	535522P		BLADES, FAN - 5 BLADES (HEAVY DUTY)	16G6,56G,57G	1
0506-6	535257P		BLADES, FAN - 4 BLADES (LESS AIR CONDITIONER)	16G8,6H	1
	535521P		BLADES, FAN - 5 BLADES (HEAVY DUTY)	16G8,6H	1
	535773P		BLADES, FAN - 5 BLADES (W/AIR CONDITIONER)	16G8,6H	1
0506-6	1540159P		BLADES, FAN - 4 BLADES - W-F-D-P-Y	56B,56H,57B,57H,57L	1
	1688823P		BLADES, FAN - 6 BLADES - W-F-D-Y (HEAVY DUTY AND AIR CONDITIONER)	56B,56H	1
	1542982P		BLADES, FAN - 6 BLADES - W-F-D-P-Y (HEAVY DUTY)	57B,57H	1
	1688823P		BLADES, FAN - 6 BLADES - W-F-D-P-Y (HEAVY DUTY, EXPORT AND AIR CONDITIONER)	57B,57H,57L	1
0506-6	535257P		BLADES, FAN - 4 BLADES - C-K	56B,56H,57B,57H	1
	535521P		BLADES, FAN - 5 BLADES - C-K (HEAVY DUTY)	56B,56H,57B,57H	1
0506-6	1540160P		BLADES, FAN - 4 BLADES	56J	J
	G179814		SCREW, TO HUB 5/16"-18X5/8"	16G6	4
	G179814		SCREW, TO HUB 5/16"-18X5/8" (FOR 535257)	16G8,6H	4
	G180078		SCREW, TO HUB 5/16"-18X7/8" (FOR 535521)	16G8,6H	4
	G179825		SCREW, TO HUB 5/16"-18X1 7/8" (FOR 535773)	16G8,6H	4
	G180084		SCREW, TO HUB 5/16"-18X1 5/8" -W-F-D-P-Y } FOR 534736, 535522, 535257 AND 1540159 FOR 1542982, 1688823 AND 535521	56G,56B,56H,57G,57B,57H	4
	G179814		SCREW, TO HUB 5/16"-18X5/8" - C-K } 1540159 FOR 56B,56H,57B,57H	56B,56H,57B,57H	4
	G179825		SCREW, TO HUB 5/16"-18X2" - W-F-D-P-Y } 1542982, 1688823 AND 535521	56B,56H,57B,57H	4
	G179821		SCREW, TO HUB 5/16"-18X1 3/8" - C-K } 535521	56B,56H,57B,57H	4
	G179826		SCREW, TO HUB 5/16"-18X2" } W/ 57H	57H	4
	G179827		SCREW, TO HUB 5/16"-18X2 1/4" -H.D. } SUPERCHARGER 57H	57H	4
	G179826		SCREW, TO HUB 5/16"-18X2" (FOR 1540159)	57L	4
	G180091		SCREW, TO HUB 5/16"-18 (H.D. EXPORT) } 57L	57L	4
	G179827		SCREW, TO HUB 5/16"-18X2 1/4" } FOR 1688823 57L	57L	4
			(W/AIR CONDITIONER)		
	G181313		SCREW, TO HUB 1/4"-28X3/4"	56J	4
	G120214		WASHER, LOCK 5/16"	ALL EXCEPT 56J	4
	G120380		WASHER, LOCK 1/4"	56J	4
	537524		SPACER, FAN BLADES - W-F-Y (W/AIR COND.)	16G8,6H	1
	1539063		SPACER, FAN BLADES - W-F-D-P-Y	56G,56B,56H,57G,57B,57H	1
	534341		SPACER, FAN BLADES - C-K (FOR 535521)	56B,56H,57B,57H	1
	1542321		SPACER, FAN BLADES (W/SUPERCHARGER)	57H,57L	1
	537524		SPACER, FAN BLADES (W/AIR COND.)	57L	1
0506-10	534468		PULLEY, FAN DRIVE	16G6,56G,57G	1
0506-10	534735		PULLEY, FAN DRIVE - NOTE 5	16G8	1
0506-10	536739		PULLEY, FAN DRIVE - NOTE 6 (LESS AIR COND.)	16G8,6H,56B,56H,57B,57H,57L	1
0506-10	534735		PULLEY, FAN DRIVE (W/AIR COND. AND H.D. EXPORT)	16G8,6H,56B,56H,57B,57H	1
	534735		PULLEY, FAN DRIVE (H.D. EXPORT)	57L	1
	1543514		PULLEY, FAN DRIVE (W/AIR COND.)	57L	1
0506-10	440773		PULLEY, FAN DRIVE	56J	1
0506-12	515112		HUB, FAN	ALL EXCEPT 56J	1
0506-12	440772		HUB, FAN	56J	1
0506-20	534853		BELT, FAN	16G6,56G,57G	1
0506-20	529374		BELT, FAN - NOTE 3	16G8	1
0506-20	536762		BELT, FAN - NOTE 4 (LESS AIR COND.)	16G8,6H,56B,56H,57B,57H,57L	1
0506-20	529374		BELT, FAN (W/AIR COND. AND H.D. EXPORT)	16G8,6H,56B,56H,57B	1
	529374		BELT, FAN (H.D. EXPORT)	57L	1
	1543639		BELT, FAN AND GENERATOR } W/AIR COND.	57L	1
	1543640		BELT, FAN AND COMPRESSOR }	57L	1
0506-20	440448		BELT, FAN	56J	1

NOTES { 5 - USED ON MODEL 16G8 U.S.A. | CANADA
 BEFORE ENGINE NOS. V-316813 | VC-5.825
 6 - USED ON AND AFTER ENGINE NOS. IN NOTE 5.

COOLING

ILLUST. NUMBER	PART NUMBER	CHANGE	DESCRIPTION	MODELS	PER CAR
0506- FAN AND BELT-Cont'd. (Plates 05-1, 2, 3)					
0506-25	535263P		SHROUD, FAN - W-F-D	16G6	1
0506-25	533186P		SHROUD, FAN - C-K	16G6	1
0506-25	535274P		SHROUD, FAN - W-F-D-Y	16G8, 6H.	1
0506-25	535282P		SHROUD, FAN - C-K	16G8, 6H.	1
0506-25	1540282P		SHROUD, FAN - C-K	56G, 57G.	1
0506-25	1540281P		SHROUD, FAN - C-K	56B, 56H, 57B, 57H.	1
	1542387P		SHROUD, FAN (W/SUPERCHARGER).	57H.	1
	1542867P		SHROUD, FAN (H.D. EXPORT AND AIR COND.)	57L.	1
0506-25	1540294P		SHROUD, FAN - K	56J.	1
0507- RADIATOR AND WATER PUMP HOSE AND CONNECTIONS (Plates 05-1, 2, 3,)					
FORMED HOSE					
0507-1	532430		HOSE, RADIATOR INLET 1 1/4" I.D. - W-F-D	16G6	1
0507-1	532431		HOSE, RADIATOR INLET 1 1/4" I.D. - C-K	16G6	1
0507-1	532174		HOSE, RADIATOR INLET 1 1/4" I.D. - W-F-D-Y	16G8, 6H.	1
0507-1	532454		HOSE, RADIATOR INLET 1 1/4" I.D. - C-K	16G8, 6H.	1
0507-1	1539058		HOSE, RADIATOR INLET 1 1/4" I.D. - W-F-D-P	56G, 57G.	1
0507-1	1539722		HOSE, RADIATOR INLET 1 1/4" I.D. - C-K	56G, 57G.	1
0507-1	1539059		HOSE, RADIATOR INLET 1 1/4" I.D. - W-F-D-P-Y	56B, 56H, 57B, 57H.	1
0507-1	1539157		HOSE, RADIATOR INLET 1 1/4" I.D. - C-K	56B, 56H, 57B, 57H.	1
	1542335		HOSE, RADIATOR INLET 1 1/4" I.D. (W/SUPERCHARGER)	57H.	1
	<u>1543552</u>		HOSE, RADIATOR INLET 1 1/4" I.D.	57L.	1
0507-1	1539087		HOSE, RADIATOR INLET 1 1/2" I.D.	56J.	1
	G111616		CLAMP, HOSE 1 5/8"	16G, 6H, 56G, 57G	2
	G111616		CLAMP, HOSE 1 5/8"	56B, 56H, 57B, 57H, 57L.	1
	G111618		CLAMP, HOSE 1 13/16"	56B, 56H, 56J, 57B, 57H, 57L.	1
	G111620		CLAMP, HOSE 1 15/16"	56J.	1
0507-4	533092		HOSE AND SPRING, WATER PUMP INLET - W-F-D	16G6	1
0507-4	533087		HOSE AND SPRING, WATER PUMP INLET - C-K	16G6	1
0507-4	532385		HOSE AND SPRING, WATER PUMP INLET - W-F-D-Y - LHC	16G8, 6H.	1
0507-4	533340		HOSE AND SPRING, WATER PUMP INLET - W-F-D-Y - RHC	16G8, 6H.	1
0507-4	532412		HOSE AND SPRING, WATER PUMP INLET - C-K	16G8, 6H.	1
0507-4	1539108		HOSE AND SPRING, WATER PUMP INLET - W-F-D-P	56G, 57G.	1
0507-4	1539364		HOSE AND SPRING, WATER PUMP INLET - C-K	56G, 57G.	1
0507-4	1539109		HOSE AND SPRING, WATER PUMP INLET - W-F-D-Y-P - LHC	56B, 56H, 57B, 57H, 57L.	1
0507-4	1539110		HOSE AND SPRING, WATER PUMP INLET - W-F-D-Y-P - RHC	56B, 56H, 57B, 57H, 57L.	1
0507-4	1539129		HOSE AND SPRING, WATER PUMP INLET - C-K	56B, 56H, 57B, 57H.	1
0507-4	1539084		HOSE AND SPRING, WATER PUMP INLET	56J.	1
	G111618		CLAMP, HOSE 1 13/16"	16G6, 56G, 57G	2
	G111618		CLAMP, HOSE 1 13/16"	16G8, 6H, 56B, 56H, 57B, 57H, 57L.	1
	G111622		CLAMP, HOSE 2 1/8"	ALL EXCEPT 16G6, 56G, 57G.	1
	G111623		CLAMP, HOSE 2 3/16"	56J.	1
	534351P		SUPPORT, RADIATOR INLET HOSE } W/POWER STEER	16G, 6H	1
	1501X10		SCREW, TO SHROUD NO. 14X3/8"	16G, 6H	2